



# Transmitter-PLC Outdoor Kit Quick Installation Guide

Rev1.0 2023/08/15



This installation guide is for customers who have purchased Transmitter-PLC-Outdoor Kit. If you have not purchased our outdoor kit, the following content is used as a reference.

note: subject to change without any notice, JDA pay no responsibility



## Transmitter-PLC-Outdoor Kit Installation

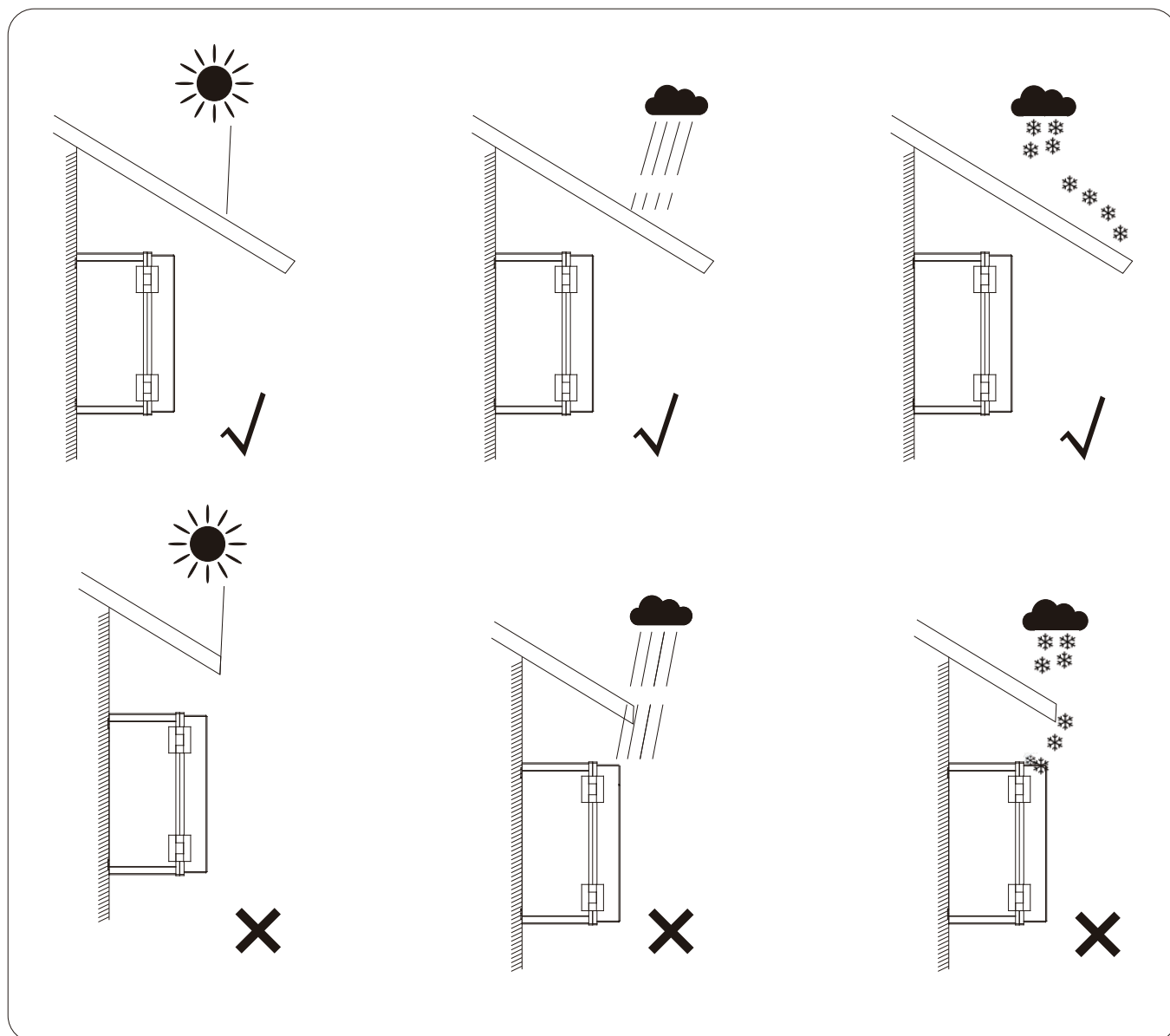

**Warning:** If the Transmitter-PLC-Outdoor Kit is installed outside, it should be protected under shelter from direct sunlight or bad weather conditions (like snow, rain, lightning, etc). Fully shielded installation locations are preferred.



## Transmitter-PLC Installation

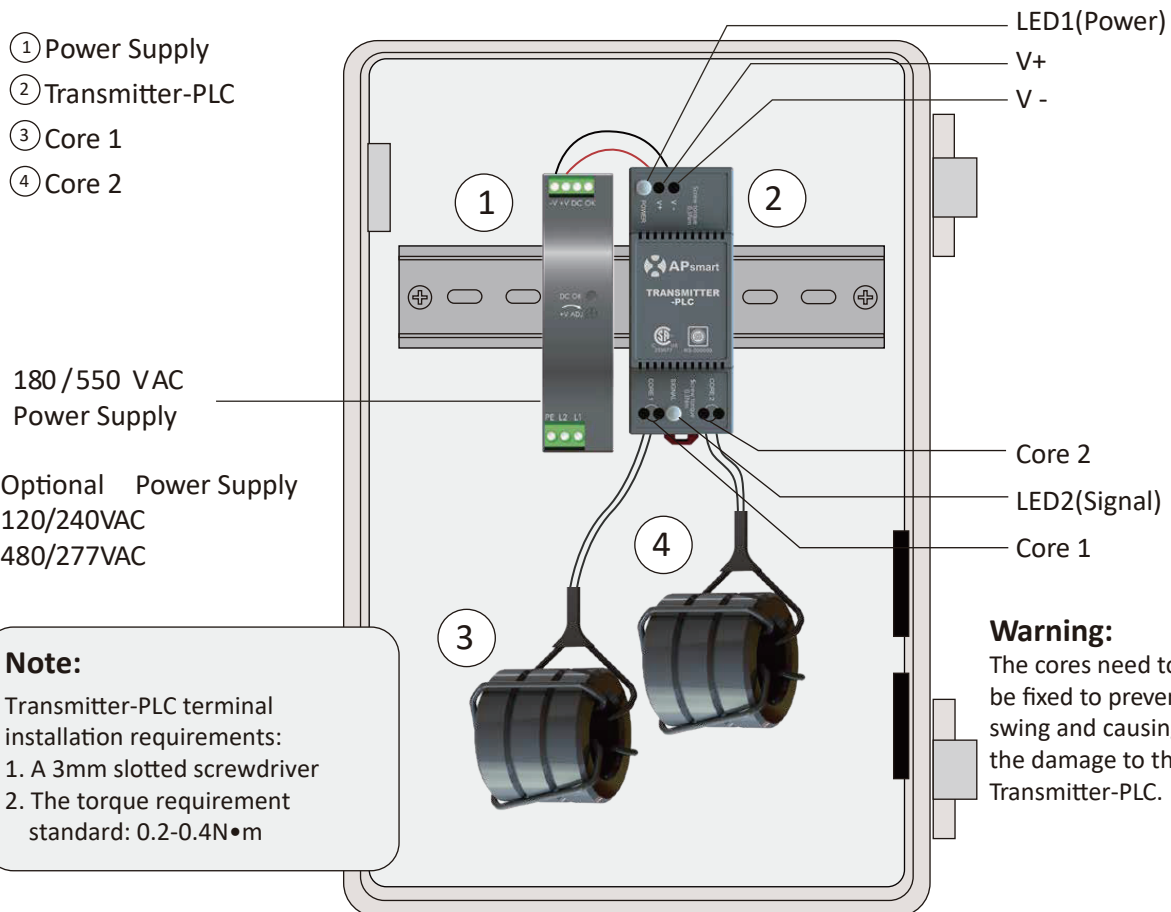

**Note:** If there is only one core needed, connect using Core 1 terminal.

Power supply must be on same AC branch circuit as inverter to meet rapid shutdown requirements.

During operation, the Power LED should be lit and the Signal LED should be blinking. When Transmitter fails to work, the Signal LED will not be blinking. If the Power LED is also not lit, check the power supply first.

**Note:** Install RSD before powering on the Transmitter.

- Mount Transmitter-PLC and power supply on DIN rail
- Connect DC leads from power supply to transmitter-PLC
- Connect dual core(Core 1 and Core 2) to transmitter-PLC

Place rapid shutdown system label no more than 1m (3ft) from Transmitter or AC disconnect if not at same location.

## Transmitter-PLC Wiring

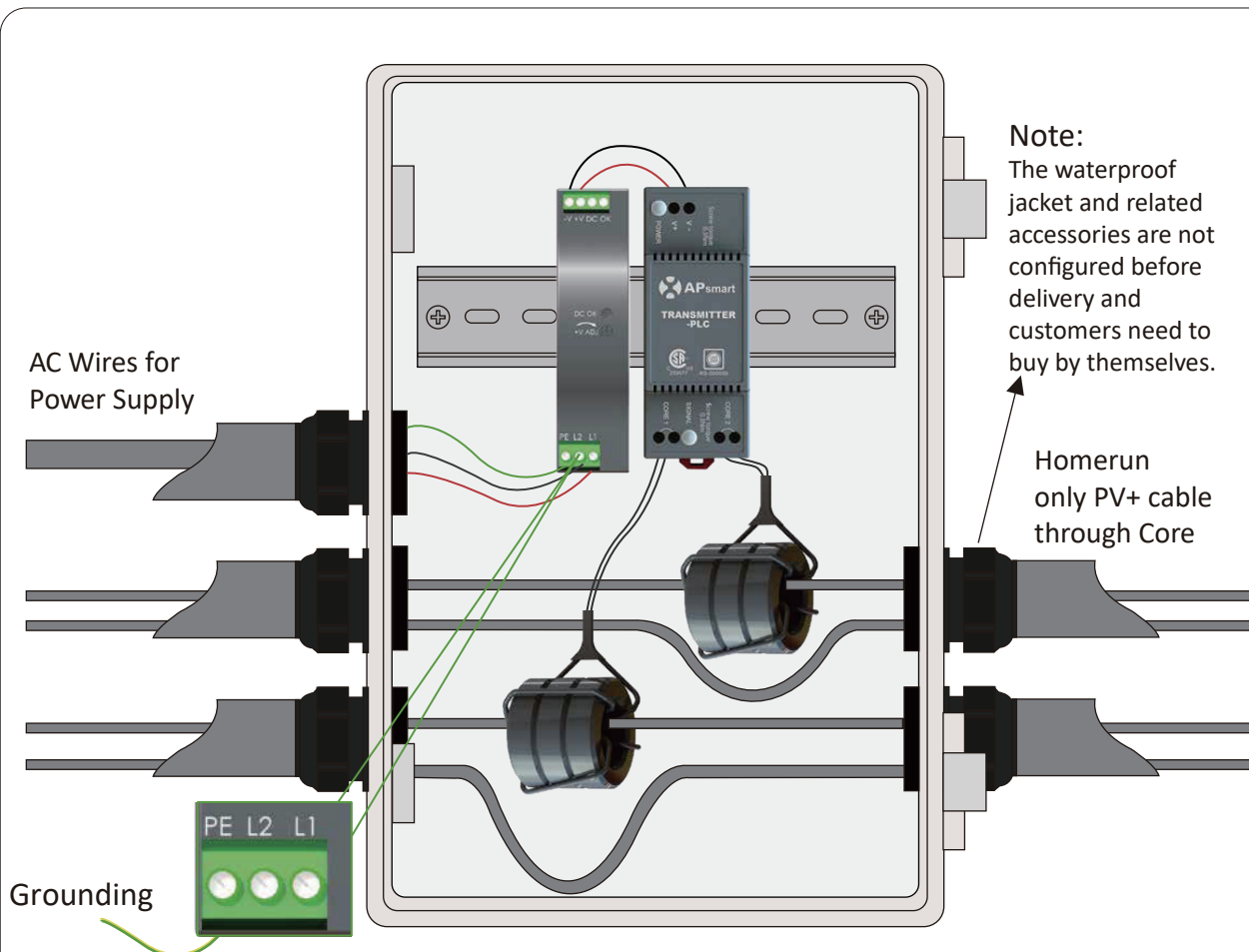

**Note:** 180/550Vac power supply isolation class I requires grounding.  
85/264Vac power supply isolation class II does not require grounding.

**Note:** Install RSD before powering on Transmitter.

- **Pass either positive or negative cables through cores**  
(either both positive cables or both negative cables. Do not use one positive and one negative cable.)
- **Connect wires to AC side of Power supply**

Max.Number of Strings Per Core :

DC Cable Diameter (without connector)	Φ5.9mm	Φ6.35mm	Φ7mm	Φ8.6mm
25mm Core	≤ 15	≤ 15	≤ 14	≤ 10
11mm Core	≤ 6	≤ 5	≤ 4	≤ 2

Max String Length: **30 modules**

Max Current Per Core: **160A (25mm) / 75A (11mm)**

Max Cable Length From Inverter (+) to Inverter (-): **800m**



## System Wiring Diagram

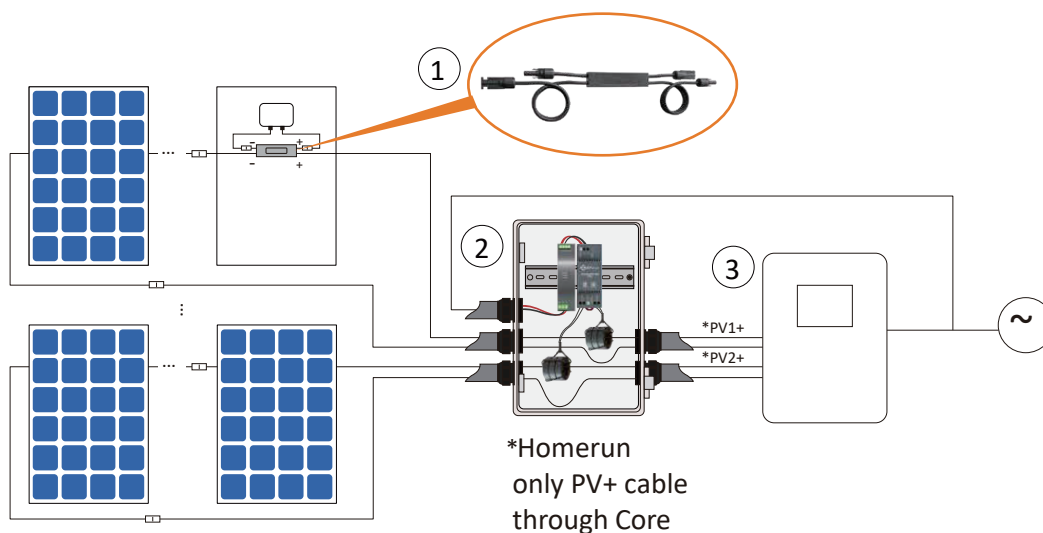

- ① RSD
- ② Transmitter-PLC Outdoor Kit
- ③ Inverter

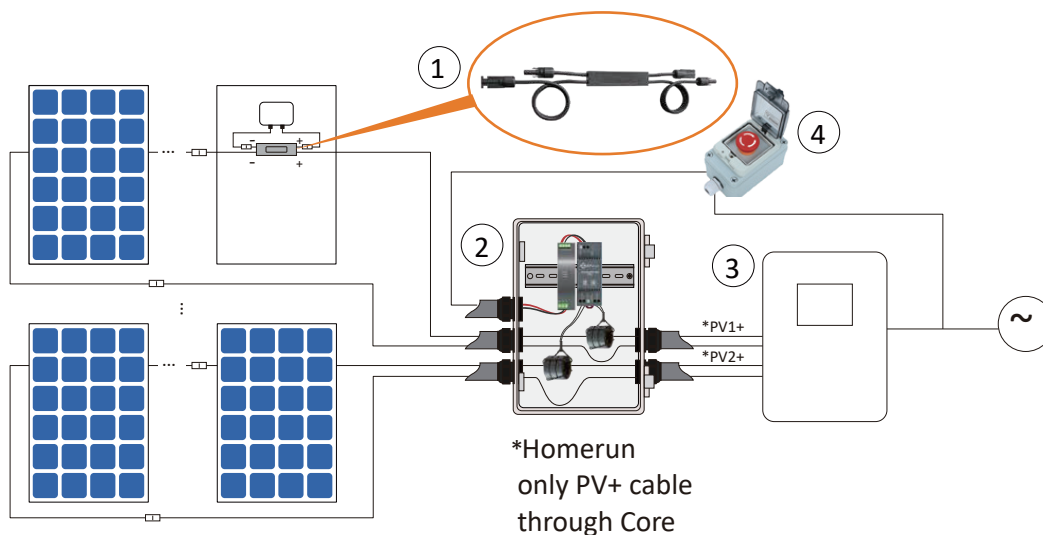

- ① RSD
- ② Transmitter-PLC Outdoor Kit
- ③ Inverter
- ④ Emergency stop button box (optional): Press the emergency stop button, the transmitter AC power supply is disconnected, the RSD closes the output, and the system rapid shutdown.



日燭國際事業股份有限公司  
JD Auspice Co., Ltd.



 [www.jdauspice.com](http://www.jdauspice.com)



 [@jdauspice](https://www.facebook.com/jdauspice)



 ID : @jdapv

